

KL-1682-44

KN 9.51

LOCKING TOOL SET, HIGH-PRESSURE PUMP SPROCKET

Applicable to Fiat vehicles equipped with either a 1.6 or 2.0 JTD Common Rail Diesel engine.

For example: Fiat Freemont, Ducato, Doblo and Doblo Cargo etc.

Engine codes: 940A5.000, 939B5.000, 250A1.000, 263A4.000, 263A5.000

For locking the high-pressure pump as well as for pressing and centring the injection pump sprocket onto the injection pump shaft. Used in conjunction with an appropriate puller, also suitable for pulling off the injection pump pulley. Indispensable tools when replacing a timing belt and/or high-pressure pump, or when performing an engine repair.



Made in Germany

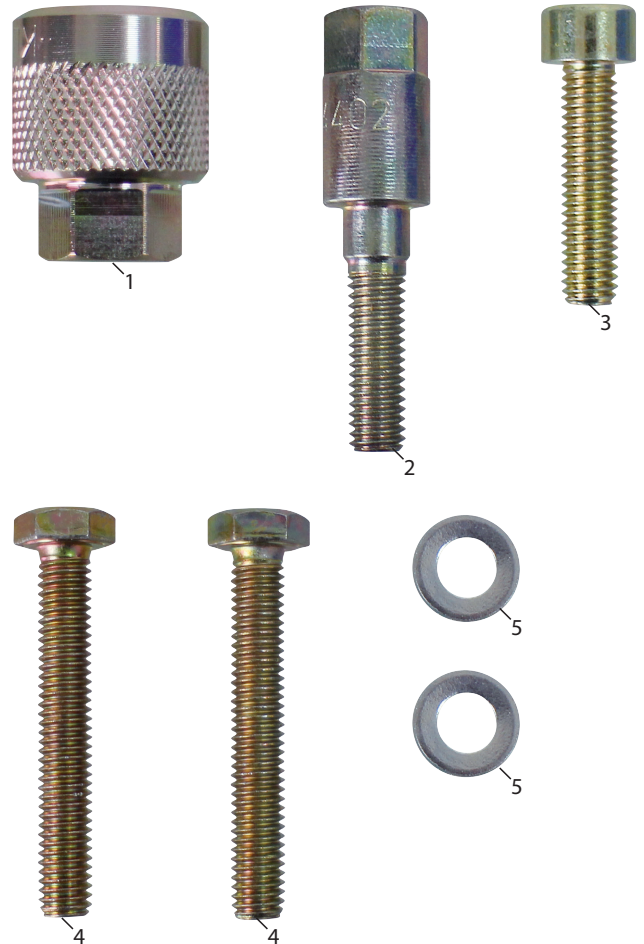

Scope of Delivery:

| Pos. | Part No. | Description | Qty |
|------|---------------------|---|-----|
| - | KL-1682-44 | Locking Tool Set, High-Pressure Pump Sprocket | 1 |
| - | <i>consists of:</i> | | |
| 1 | KL-1682-4401 | Securing Nut, M14x1.5 | 1 |
| 2 | KL-1682-4402 | Special Screw, M6 | 1 |
| 3 | KL-0055-0012 | Cheese Head Screw, M6x25mm | 1 |
| 4 | KL-1682-4403 | Hex Screw, M6x40mm | 2 |
| 5 | KL-0008-0013 | Washer, Ø 6mm | 2 |