

KL-0186-95 K, Code 3279286

KN 9.92

INJECTOR EXTRACTOR SET (VM-MOTORI / HATZ-DIESEL / IVECO)

Universally fits agricultural machines, construction machines, and municipal vehicles with engines from VM-Motori as well as HATZ-Diesel and Iveco. For example, the motor series: VM-Motori R754 (Euro 5 + Euro 6), R756 (Euro 6); HATZ-Diesel H-Serie 3H50 TIC, 4H50 TIC; Iveco F1CE3 (Euro 5), 8140.43 (Euro 3).

For example, installed at Aebi, Boki, Boschung, Bulmor, Bucher, Hako, Hansa, Kärcher, Ladog, Lindner, Meili, MFH, Reform, Schell, Schmidt, Triletty.

For quick and professional extraction of stuck injectors from the cylinder head, in conjunction with an impact extractor (mounting thread: M18x2.5). It is required when removing the valve cover, for example, and when renewing the injectors.

The special design of the injector extractor allows the injector to be pulled out without having to open it, directly above the fuel connection. Injectors that have been opened must be sent in for repair according to the manufacturer's instructions.

Required drive parts (See Chapter Drives):

KL-0369-4100 - Impact extractor 1.5 kg,

KL-0049-300 - Impact extractor 4.8 kg

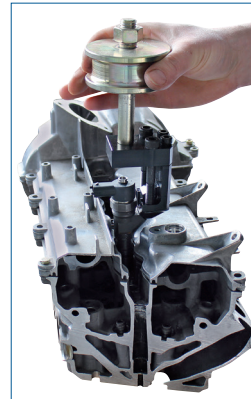

Made in Germany

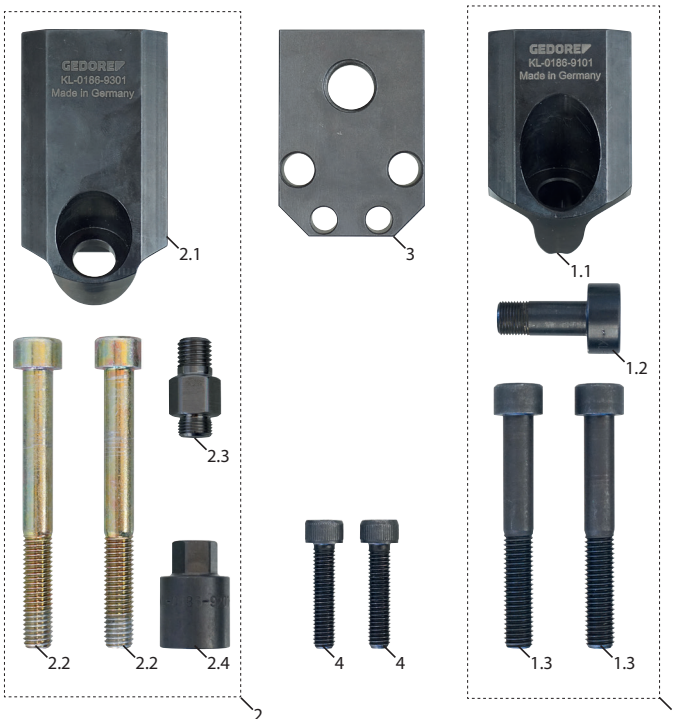

Scope of delivery:

Item	Part no.	Description	Quantity
-	KL-0186-95 K	Injector extractor set (VM-Motori / HATZ-Diesel / Iveco)	1
<i>consisting of:</i>			
1	KL-0186-951	Injector extractor HATZ H-series	1
1.1	KL-0186-9101-1	Adapter plate M14x1.5 / 45°	1
1.2	KL-0186-9101-3	Special screw M14x1	1
1.3	KL-0186-9000-2	Cheese-head screw M8x35 mm	2
2	KL-0186-952	Injector extractor VM-Motori	1
2.1	KL-0186-9301-1	Adapter plate Denso M14x1.5 / 30°	1
2.2	KL-0186-9000-4	Cheese-head screw M10x90	2
2.3	KL-0186-9001-5	Adapter M12x1 / M12x1.5	1
2.4	KL-0186-9201-2	Threaded sleeve M12x1.5	1
3	KL-0186-9000-1	Nozzle extractor Head plate	1
4	KL-0186-9000-2	Cheese-head screw M8x35mm	2
-	KL-0186-9090	Plastic suitcase	1

* All information and prices are subject to typographical and printing errors.